



**Decoland Poly Lock**

Insulation accessories



Scan for more info



# Decoland Poly Lock

Due to the high need of fixing the HDPE liner to concrete walls in different works, especially in the structure sealing and foundation projects, Decoland has decided to produce an E-Profile which is used mainly for this purpose. The Poly Lock E-Profile is made of HDPE resin with carbon black of not less than 2%. This E-Profile has three T shape anchors which allow the profile to be embedded strongly with the concrete wall and give it a strong bonding.

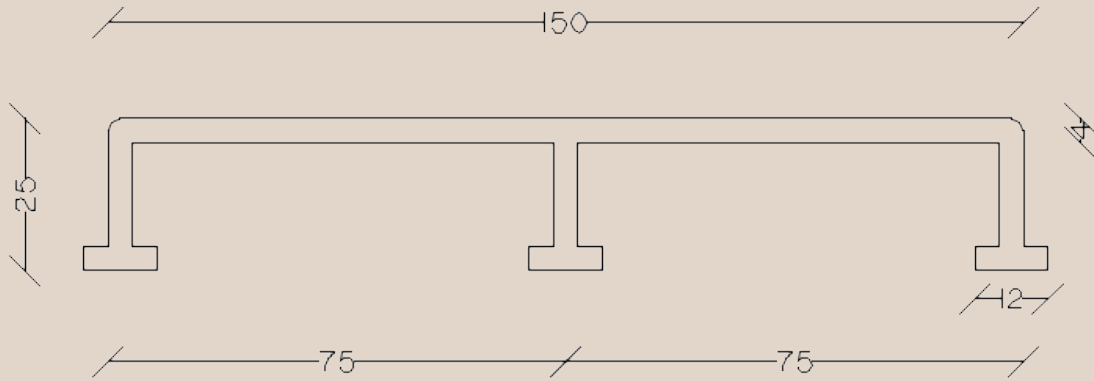

## Dimensions

Properties	Value	Units
Length of rod :	4	m
Thickness:	4	mm
Width :	150	mm
Anchor finger length :	25	mm
Width of nodes :	12	mm

Note: Length of rod can be produced according to client requirements.

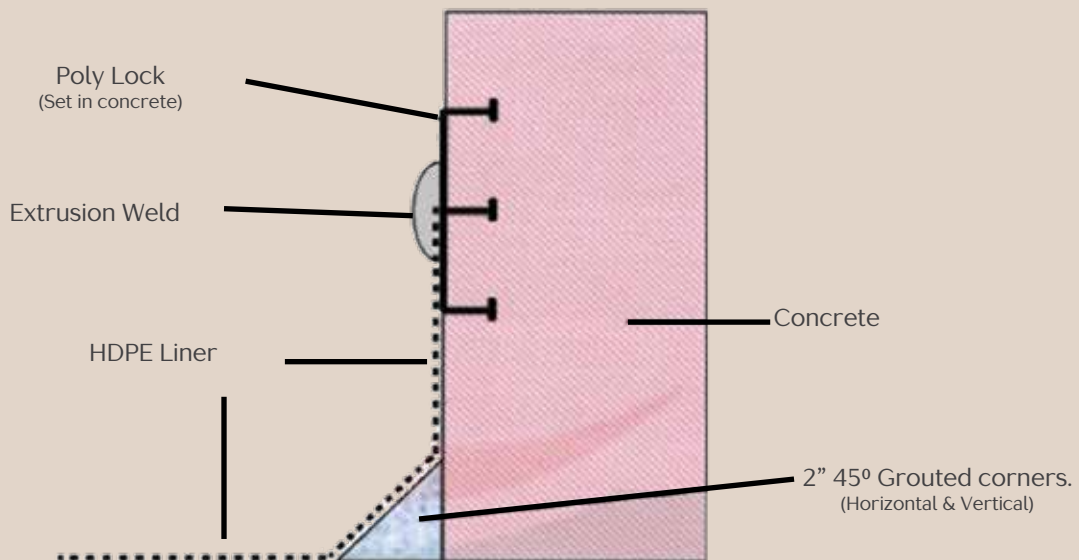

## Contact:

Decoland Tec. Landscape  
 T: +20 11 1199 5970  
 +20 2 2573 8660

E: [info@decoland-egy.com](mailto:info@decoland-egy.com)  
 W: [www.decoland-egy.com](http://www.decoland-egy.com)  
 Fb: Decoland tec. Landscape  
 in: [decoland-tec-landscape/](https://www.facebook.com/decoland-tec-landscape/)

Office: Plot 238, Small Industries Area,  
 North Katameya Ain Sokhna Road,  
 3rd Settlement, New Cairo, Egypt.  
 Factory: Plot 9 & 14, New Industrial Zone,  
 Fayoum, Egypt.