

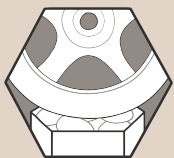

BERA  GRAVEL FIX[®]
ME

Gravel Stabilization System





BERA® The GREEN Solutions Provider

Water facts:

Ground water is rainwater that has seeped into the substrate. It is important for the production of drinking water and prevents agricultural and wildlife areas from drying out. The water crisis is the #1 global risk based on impact to society (as a measure of devastation), and the #8 global risk based on likelihood (of occurring within 10 years) as announced by the World Economic Forum, January 2015. - source: water.org.

SUSTAIN WATER FOR FUTURE GENERATIONS

Gravel Fix ME your solution!

- Stable and strong gravel paving for traffic and pedestrian use,
- Immediate rainwater infiltration, 90-liter/sec per m²,
- Sustainable in its application,
- For parking, driveways and pedestrian areas.

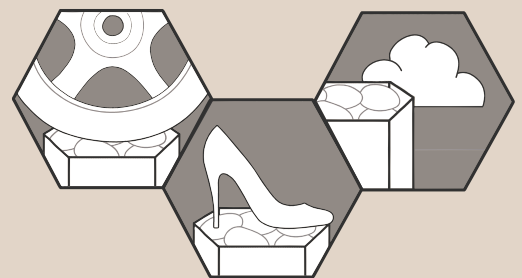

Decoland Egypt manufacturing facilities.

INTRODUCTION

What is Gravel Fix ME?

Gravel Fix ME is an advanced recyclable stabilization system for gravel, shells, mulch and sand. With its hexagonal honeycomb-like structure of high quality Polypropylene cells, Gravel Fix ME is designed to provide a strong and stable sub-base for the professional application of gravel on paths, driveways, car parks and roofs. Installed by professional contractors it will facilitate a strong and porous surface for residential and urban projects. **The Gravel Fix “ME” version is suitable for Gulf region and Middle East environmental conditions.**

Applications:

- & Landscaping of urban areas
- & Residential villa gardens and terraces,
- & Parking and gravel driveways,
- & Service access routes.

Features and benefits of Gravel Fix ME:

- & Easy to install and stable gravel surface in fast and economic way,
- & Two sizes, M, L from 0.3 - 0.9 m²
- & For pedestrian and vehicle use, even trucks,
- & Easy mobility for all including those wearing high-heels or with bicycles, motorbike or wheelchair,
- & Terrace furniture, ladders are stable and not sinking in,
- & Fully porous, so dry and ensuring infiltration of rainwater immediately,
- & Fitted geotextile for maximum porosity and weed growth reduction.

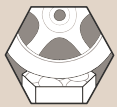

For your vehicle use and parkings



For maximum mobility and stability on paths and walkways



For green roofing with sedum or stable base for (roof) terraces



UV resistance included



Made in Egypt by Decoland

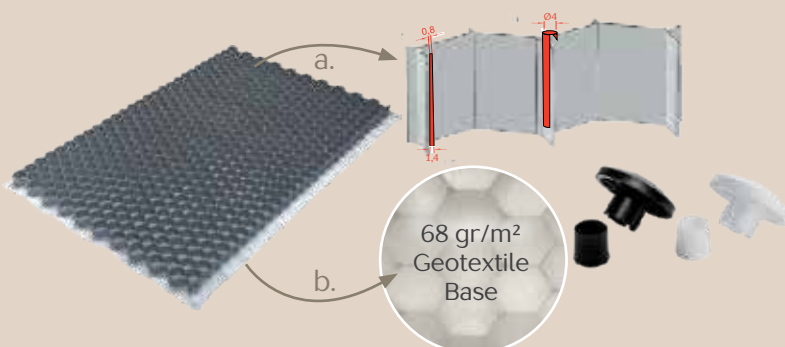

Did You Know?

- a. Gravel Fix ME has 32 mm deep, tapered cell walls of 1.4 mm at the base and 0.8 mm at the top to ensure the highest vertical strength,
- b. 68 gr/m² Geotextile for maximum drain-ability,
- c. Parking Markers available for organizing your parking lots.





TECHNICAL

Environmental and Engineering Excellence

Gravel Fix ME is manufactured in Egypt under stringent quality and environmental Control standards.

The use of pure raw materials (100% recyclable) and well developed infrastructure to minimize our delivery carbon footprint, underline our corporate vision in providing environmentally sustainable solutions.

Gravel Fix ME, a sustainable product:

-  Manufactured in Egypt using latest technology,
-  Fully recyclable after end of life-cycle,
-  UV resistant,
-  No glue, only thermally welded connections.

Technical Specifications*

GENERAL

Material	:	100% Pure polypropylene, 100% recyclable
Manufacturing technique	:	High precision green injection molding
Manufacturing location	:	Egypt
Color	:	White, gray, black or green (Other colors available upon request).
Cell structure	:	Hexagonal
Membrane	:	68 gr/m ² PET Polyester Spunbonded Nonwoven
Drain-ability	:	90 Liter / (m ² .s)
UV and frost	:	UV resistant

PHYSICAL DATA

Model	:	ME - M	ME - L
Dimensions L x W x H (mm)	:	764 x 392x 32 (+/-5%)	1176 x 764 x 32 (+/-5%)
Installed surface (m ²)	:	0.3	0.9
Cell size (mm)	:	42	42
Wall thickness, tapered (mm)	:	0.8 - 1.4 mm	0.8 - 1.4 mm
Gravel/split volume/weight	:	50 l/m ² = 75 kg/m ² - size between 3 and 16 mm	50 l/m ² = 75 kg/m ² - size between 3 and 16 mm
Vertical strength, empty (T/m ²)	:	90	90
Vertical strength, installed (T/m ²)	:	> 450 Depending on gravel/split	> 450 Depending on gravel/split

* In favor of product improvements, producer may change specifications without prior notice.

* Gravel Fix ME is frequently used on light slopes including driveways. Specific requirements on the application depend on the circumstances on site. Please contact the manufacturer or the dealer for further advise.



PET Polyester Spun-bonded Non-woven

Geotextile for Gulf Area & Middle East

Essential characteristics	Test Method	Unit	Performance
Breaking strength	ASTM D4595	kN/m	MD 245 CMD 130
Elongation at break	ASTM D4595	%	MD 28 CMD 28
Weight	ASTM D3776	gr/m ²	68
Dimensions (W/L/T)	ASTM D1777	mm	1002 x 920 x 0.11

LAYING INSTRUCTIONS

1

For path	Vehicle use
	
1.5 cm gravel 3.2 cm GRAVEL FIX ME with gravel	1.5 cm gravel 3.2 cm GRAVEL FIX ME with gravel
10 cm sharp sand or gravel	4 - 6 cm sharp sand or gravel
	15 - 25 cm crushed stone

Foundation

Foundation profile to be determined by site conditions and suitable for anticipated load. In general the foundation shall be:

For paths only: a flat layer of 10 cm sharp sand.

For vehicle use: a compacted layer of 15-25 cm MOT (crushed stone) plus 4-6 cm sharp sand.

2



Shaping

Create shape using border systems in aluminium, galvanized steel, or HDPE. Height (5-15 cm) and thickness depending on expected load. Use laser height determination for alignment with surrounding area.

3



Compacting

A stable, well compacted base, as used in all other paving methods, is essential. Failure may lead to non-performance of Gravel Fix ME as intended.

4



Leveling

After compacting, level the sand or gravel layer eliminating any surplus sand/gravel. Remove any debris or sharp items from the sand/gravel layer.

5



Laying

Each sheet has extended geotextile lips on 2 sides. Lay the sheets onto the extended geotextile lip of the adjacent sheet for maximum stability, weed control and support. Check with your supplier for specific instructions.

6



Trimming

Cut to fit to edging or obstacles using hand or electric tools to ensure sheets are firmly fixed within the edges. Important: Please follow tool manufacturers safety instructions.

7



Filling

Fill the sheets with gravel size min. 3 max. 16 mm, which should exceed the height of the cell wall by 15-20 mm. (Refer to our Technical Documentation for further details).

8



Finishing

Rake the gravel to distribute evenly. Maintenance is limited to raking and removing leaves and other debris. Important: Keep the sheets covered with gravel for maximum durability. Top-up gravel as and when required to keep the sheets covered.

APPLICATION REFERENCES

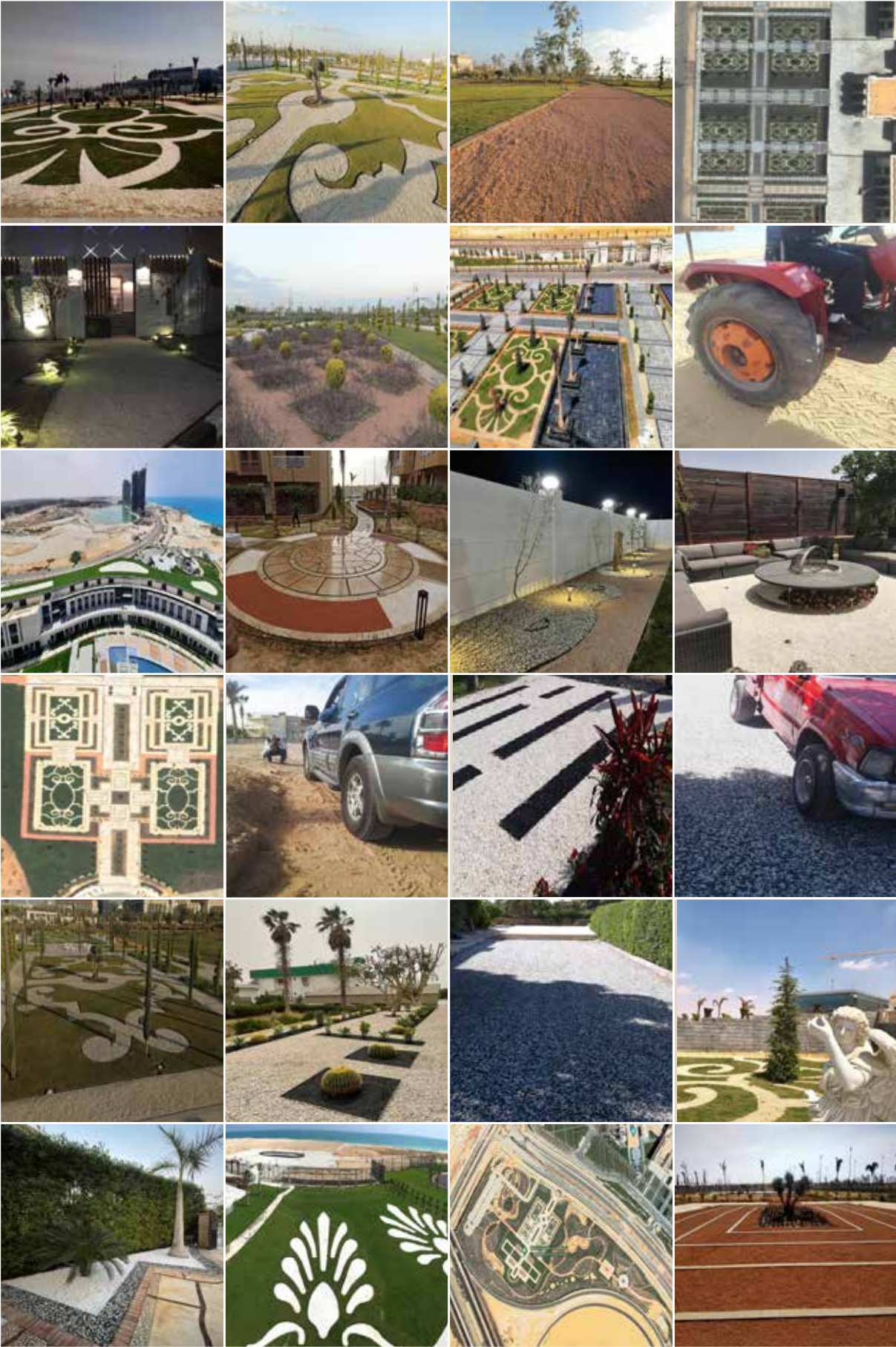



Decoland

Landscaping Innovative
Sustainable Solutions

DECOLAND was founded in Egypt in 2012 as an Eco-friendly company to develop, manufacture, & distribute 'green' products and solutions for landscapes and urban spaces. We have built an edge in the market in which we provided ecological sustainable solutions with high technology, high quality and unique applications.

Based on long standing cooperation with BERA we have gained their trust and obtained an exclusive license to locally produce the Honeycomb[®] (Gravel Fix ME), Aluminium separators and HDPE Edges in Egypt.

T: +20 11 1199 5970
+2 02 2573 8660

W: www.decoland-egy.com

E: info@decoland-eg.com

in: [decoland-tec-landscape/](https://www.instagram.com/decoland-tec-landscape/)

FB: Decoland tec. landscape

Office:

Plot 238, Small Industries Area,
North Katameya-Ain Sokhna Road
3rd Settlement, New Cairo, Egypt

Factory:

Plot 9 & 14, New Industrial Zone,
Faiyum - Egypt



BERA[®] is the trademark of BERA B.V of The Netherlands, a company which develops stabilization systems, eco systems and prestigious outdoor living concepts.

With the company's historical roots and wealth of know-how in landscaping and architectural fields, they create innovative and environmentally sustainable solutions, supplied throughout Europe, the Middle-East, Africa, Central America and S-E Asia regions.

BERA B.V (The Netherlands)

T: +31 (0) 33 257 0302

E: info@bera-bv.com

